



**Controlfix** Installation in a concrete slab/floor

Products

Illustration and dimensioned drawing

Article description

Outer diameter  
Ø (mm)

Article #

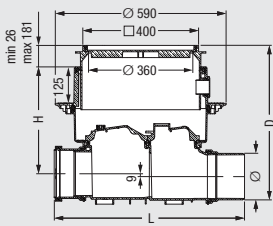

Installation area 750 x 750 mm

**Clean out Controlfix for wastewater**

made of polymer, with telescopic upper section for continuous height- and level adjustment

**For installation in a concrete slab/floor for installation depth (D) from 486 - 640 mm**

**1 with recessed cover for on-site tiling (X)**

**2 with black cover (S)**

With surface water tight cover plate class A 15 made of polymer. Installation kit with choice of cover.

- Ø 110 L: 642 mm H: 394 mm
- Ø 125 L: 645 mm H: 387 mm
- Ø 160 L: 656 mm H: 370 mm
- Ø 200 L: 720 mm H: 348 mm

1

2

- Ø 110
- Ø 125
- Ø 160
- Ø 200\*

- Ø 110
- Ø 125
- Ø 160
- Ø 200\*

- 80100X
- 80125X
- 80150X
- 80200X

- 80100S
- 80125S
- 80150S
- 80200S

**+** Accessories: Page 32 - 35

**Controlfix** Installation in an exposed wastewater pipe

Products

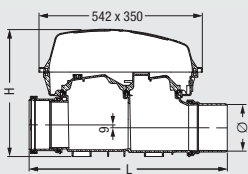

**Clean out Controlfix for wastewater**

made of polymer

**For installation in an exposed wastewater pipe. With protective cover.**

- Ø 110 L: 642 mm H: 422 mm
- Ø 125 L: 645 mm H: 422 mm
- Ø 160 L: 656 mm H: 422 mm
- Ø 200 L: 720 mm H: 422 mm

- Ø 110
- Ø 125
- Ø 160
- Ø 200\*

- 80100
- 80125
- 80150
- 80200

**+** Accessories: Page 32 - 35