



Engineering system base *Aqualift F XL Mono / Duo*

With macerator pumps

Illustration and dimensioned drawing

Article description

Pump STZ

Voltage

Pumping-
volume

Article #

Wet
installation

NEW

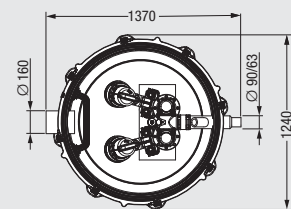
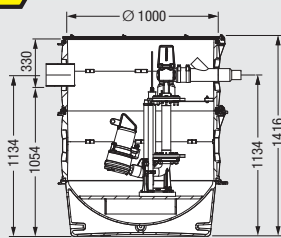

Engineering systems base
 with welded on chamber ring
Aqualift F XL Mono / Duo pumping station
ATEX version
 for wastewater with or without sewage

Tank volume approx. 680 liters
Pumping volume approx. 310 liters
**For installation in a concrete slab and
 for outdoor underground installation in
 combination with system chamber**
Handles groundwater depth up to 3000 mm
 Inlet \varnothing 160 mm /
 pressure pipe connection \varnothing 63 / 90 mm.

1	Mono version with Comfort control unit,	1300-S1	400 V	310 liters	874 30 14
	with one STZ pump, 400 V, with hydrostatic sensor	2500-S1	400 V	310 liters	874 30 15
	including backflow preventer closure valve on pressure pipe side	3700-S1	400 V	310 liters	874 30 16
2	Duo version with Comfort control unit,	1300-S1	400 V	300 liters	874 30 17
	with two STZ pumps, 400 V, with hydrostatic sensor	2500-S1	400 V	300 liters	874 30 18
	including backflow preventer and closure valves on pressure pipe side	3700-S1	400 V	300 liters	874 30 19

10 m cable length (30 m on request)

Welded PE pipe is to be used
for the pressure pipe

Accessories:
see page 132-133

Necessary system chambers:
see page 130-131

Underground installation

To be ordered separately:

**System chambers
Including upper sections
and covers**

- for installation in the ground
(For order items see page 130-131)
- for installation in a concrete slab
(For order items see page 131)

Approval Z-42.1-527

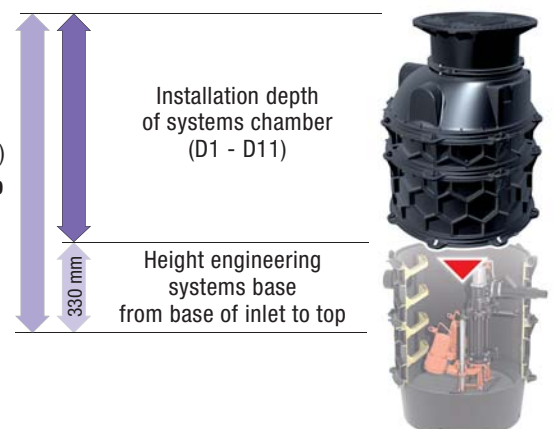

SmartSelect simply makes planning
easier - calculation tool for lifting
stations at smartselect.kessel.com

Pumping stations for wastewater with sewage

Underground installation outside buildings



- ① Pumping station
② Engineering systems chamber
③ Pressure pipe

The pumping station *Aqualift F XL* handles large quantities of wastewater containing sewage, and is thus suitable not only for typical residential buildings but also particularly for commercial and industrial use. Due to its macerating pumps the system is explosive proof. The pumping stations have a modular design. Depending on the area of application, they can be combined with different system chambers.

Professional advantages

- Pneumatische niveauregistratie of niveau-sonde, schakelhoogten variabel instelbaar.
- Macerating pumps (Mono/Duo) in various capacity classes from 1.3 kW to 3.7 kW.
- High pumping volume approx. 310 liters
- Closure valve with safety hoop to prevent unintentional closing.
- Pressure pipe connection – Valve with integrated backflow preventer for easy draining of the pressure pipe.
- Tank floor resistant to groundwater depths up to 3000 mm.
- Control units with self-diagnosis system SDS for monitoring pump and battery buffering with monthly self-test. Comfort version with multi-line display for operating state and maintenance instruction as well as user-friendly menu guidance in six languages.



Scan this QR code to directly view the corresponding product video.



Pump type:

STZ 1300-S1 for continuous duty (e.g. rainwater)

Pumping capacity: max. 20 m³/h
Pumping height: max. 21 m

STZ 2500-S1 for continuous duty (e.g. rainwater)

Pumping capacity: max. 21 m³/h
Pumping height: max. 33 m

STZ 3700-S1 for continuous duty (e.g. rainwater)

Pumping capacity: max. 28 m³/h
Pumping height: max. 35 m

Performance Diagram

